

A2030TiiHL

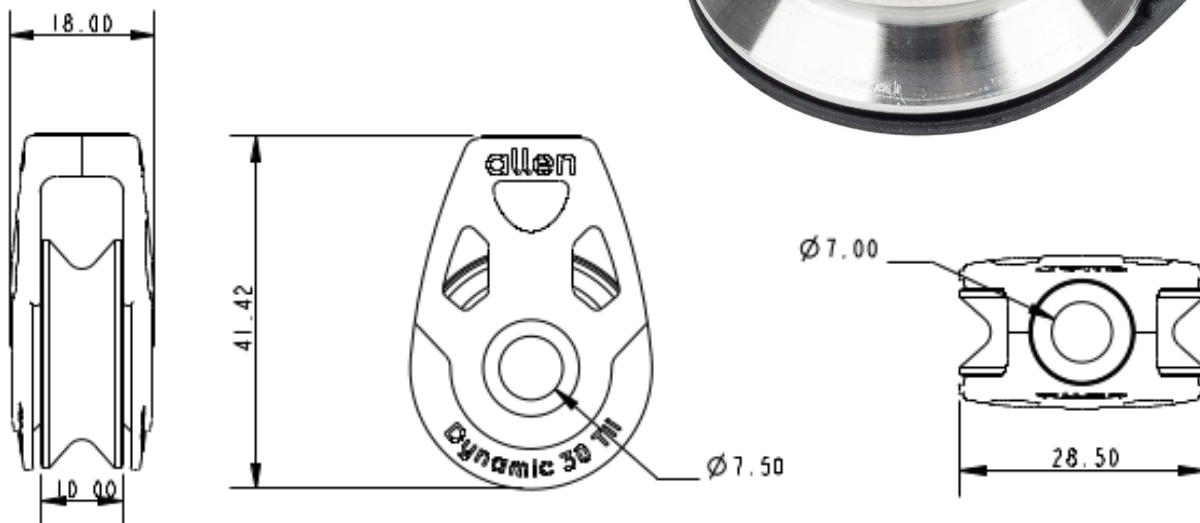

- **Product Description:** Tii-On Block With High Load Sheave
- **Sheave Diameter:** 30mm
- **Max Line Diameter:** 8mm
- **Breaking Load:** 800g
- **Maximum Working Load:** 300Kg
- **Weight:** 37g
- **Length:** 41m



Details: This HL version of the A2030Tii also includes the high load sheave from our popular range of high load blocks. A stainless steel sheave running on our dynamic stainless steel bearings provides higher working loads and better performance compared to our standard acetal sheave range.

The popular performance range of Allen Tii blocks are designed for soft attachment applications. Perfect for use in systems where weight saving is a necessity or there is no requirement for a metal shackle.

Allen Tii blocks feature a standout difference from their competition. A stainless-steel ring at the head of the block. The ring is designed to strengthen the block so that any cheek splitting loads are dissipated, allowing for higher working loads when compared to competitors tie on blocks in the same category.